



# Total Pond

SePRO Total Pond -

# Emerge<sup>®</sup>

Cattail & Shoreline Weed Control



Spring Summer Fall  
Recommended Application Timing

## Controls shoreline nuisance vegetation

- Kills broadleaf and grass weeds
- Provides a complete kill, including the roots
- Safe to apply to weeds around water

Controls emergent weeds around water: Shorelines, rivers and streams, docks and ditch banks.

### Active Ingredient:

glyphosate: N-(phosphonomethyl)glycine, isopropylamine salt ..... 53.8%

Other Ingredients ..... 46.2%

TOTAL ..... 100.0%

Contains 5.4 lb per gallon glyphosate, isopropylamine salt (4 lb per gallon glyphosate acid)

# KEEP OUT OF REACH OF CHILDREN CAUTION

### Application Guidance

Mix 3 oz. of this product to 1 gallon of water  
Add an aquatic non-ionic surfactant  
One pint treats up to 1,600 square feet

Rainfast in 6 hours, typically provides visible results in 5-7 days

**Agricultural Chemical:** Do not ship or store with food, feeds, drugs or clothing.

### DIRECTIONS FOR USE

It is a violation of Federal Law to use this product in a manner inconsistent with its labeling. Read all *Directions for Use* carefully before applying.

### How SePRO Total Pond - Emerge works

This product is a systemic herbicide that when absorbed through the leaves, moves down through the plant into the root system. It inhibits an enzyme found only in plants (not in humans or animals), essential to forming amino acids. Glyphosate is strongly absorbed to soil and is readily degraded by soil microbes. This product will not move in soils to untreated plants. Wilting and yellowing of treated plants will occur within 5 - 7 days and progress gradually throughout the plant.

### When to apply

Apply this product when weeds are emerged and actively growing. Spray when the air is calm to minimize drift to desirable plants. Avoid spraying desirable plants as severe injury may result. Product is rainfast after 6 hours.

### Where to apply

- along shorelines of lakes, reservoirs and ponds
- around docks or piers
- berms
- canals
- ditch banks
- drainage or irrigation channels
- embankments
- riparian zone (vegetated area along streams or rivers)
- riprap and other erosion control measures
- wetlands and other natural areas

### How to apply

- This product mixes readily with water. Add 3 oz to 1 gallon of water to sprayer tank. Add an aquatic non-ionic surfactant at a rate specified on that product's label.
- Close sprayer, shake/swirl well.
- If possible, adjust nozzle tip to apply a coarse spray. Spray directly on plants you want to control until they look glossy wet.

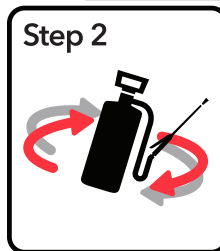
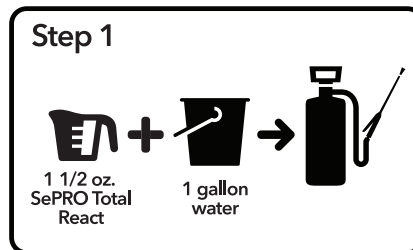

- One gallon of spray solution covers approximately 300 sq. ft.
- Makes 5.3 gallons, treats 1,600 sq. ft.

### **Tips for Best Results**

- Apply to foliage of vegetation to be controlled, insure complete, uniform coverage.
- Some species may require retreatment to achieve complete control.
- This product does not control plants that are completely submerged or have a majority of their foliage under water. Do not apply this product directly to water where no emergent vegetation is growing.
- There are no restrictions on the use of treated water for irrigation, recreation or domestic purposes.

### **Use SePRO Total Pond - Emerge to Treat Susceptible Weeds:**

alligator weed	spatterdock/cow lily
American lotus	torpedograss
cattail	waterhyacinth
phragmites spp.	waterlettuce
purple loosestrife	waterprimrose
sedge spp.	willow spp.
smartweed spp.	

### **Aquatic Sites**

This product may be applied to emerged weeds in all bodies of fresh and brackish water that may be flowing, nonflowing or transient including the following:

- along shorelines of lakes, reservoirs and ponds
- around docks or piers
- berms
- canals
- ditch banks
- drainage or irrigation channels
- embankments
- riparian zone (vegetated area along streams or rivers)
- riprap and other erosion control measures
- wetlands and other natural areas

If aquatic sites are present in the noncrop area and are part of the intended treatment, read and observe the following directions:

- Consult local and state fish and game agency and water control authorities before applying this product to public water. Permits may be required to treat such water.
- To make aquatic applications around and within 1/2 mile of active potable water intakes, the water intake must be turned off for a minimum period of 48 hours after the application. The water intake may be turned on prior to 48 hours if the glyphosate level in the intake water is below 0.7 parts per million as determined by laboratory analysis. These aquatic applications may be made only in those cases where there are alternative water sources or holding ponds which would permit the turning off of an active potable water intake for a minimum period of 48 hours after the application.

- For treatments after draw down of water or in dry ditches, allow 7 days or more after treatment before reintroduction of water to achieve maximum weed control. Apply this product within 1 day after draw down to ensure application to actively growing weeds.
- Floating mats of vegetation may require retreatment. Avoid wash off of sprayed foliage by spray boat or recreational boat backwash or by rainfall within 6 hours of application. Do not re-treat within 24 hours following the initial treatment.
- Applications made to moving bodies of water must be made while traveling upstream to prevent concentration of this herbicide in water. When making any bankside applications, do not overlap more than 1 foot into open water. Do not spray in bodies of water where weeds do not exist. The maximum application rate of 7 1/2 pints per acre must not be exceeded in any single broadcast application that is being made over water.
- When emerged infestations require treatment of the total surface area of impounded water, treating the area in strips may avoid oxygen depletion due to decaying vegetation. Oxygen depletion may result in fish kill.

### **Restrictions:**

- Do not apply this product directly to water within 1/2 mile upstream of an active potable water intake in flowing water (i.e., river, stream, etc.), or within 1/2 mile of an active potable water intake in a standing body of water, such as a lake, pond or reservoir. This restriction does not apply to intermittent inadvertent overspray of water in terrestrial use sites.
- Do not spray open bodies of water where woody brush, trees and herbaceous weeds do not exist. Do not apply more than 7 1/2 pints per acre in a single over water broadcast application except in stream crossings in utility right-of-way or where applications will result in less than 20 percent of the total water area being treated. In either of these locations, any specified rate may be applied.

## **Precautionary Statements**

### **Hazards to Humans and Domestic Animals**

#### **CAUTION**

**Harmful If Inhaled. Avoid breathing spray mist. Remove contaminated clothing and wash before reuse. Wash thoroughly with soap and water after handling.**

### FIRST AID

**If inhaled:** Move person to fresh air. If person is not breathing, call 911 or an ambulance, then give artificial respiration, preferably mouth-to-mouth if possible. Call a poison control center or doctor for further treatment advice.

### HOTLINE NUMBER

Have the product container or label with you when calling a poison control center or doctor, or going for treatment. In case of emergency endangering health or the environment involving this product, call **INFOTRAC** at **1-800-535-5053**.

### Environmental Hazards

Do not contaminate water when cleaning equipment or disposing of equipment washwaters. Treatment of aquatic weeds can result in oxygen depletion or loss due to decomposition of dead plants. This oxygen loss can cause fish suffocation.

In case of leak or spill, soak up and remove to a landfill.

### Physical or Chemical Hazards

Spray solutions of this product should be mixed, stored, and applied using only stainless steel, aluminum, fiberglass, plastic or plastic-lined steel containers.

Do not apply this product in a way that will contact applicator or other persons, either directly or through drift. Only protected handlers may be in the area during application. For any requirements specific to your state or tribe, consult the agency responsible for pesticide regulations.

Do not mix, store or apply this product or spray solutions of this product in galvanized steel or unlined steel (except stainless steel) containers or spray tanks. This product or spray solution of this product react with such containers and tanks to produce hydrogen gas, which may form a highly combustible gas mixture. This gas mixture could flash or explode causing serious person injury. If ignited by open flame, spark, welder's torch, lighted cigarette or other ignition source.

### STORAGE AND DISPOSAL

Do not contaminate water, food, feed or seed by storage or disposal.

**Pesticide Storage: Store above 10°F (-12°C) to keep product from crystallizing.** Crystals will settle to the bottom. If allowed to crystallize, place in a warm room 68°F (20°C) for several days to redissolve and roll or shake container or to mix well before using.

**Container Handling:** Nonrefillable container. Do not reuse or refill this container. If empty: Place in trash or offer for recycling if available. If partly filled: Call your local solid waste agency for disposal instructions. Never place unused product down any indoor or outdoor drain.

**Warranty Disclaimer:** SePRO Corporation warrants that this product conforms to the chemical description on the product label. Testing and research have also determined that this product is reasonably fit for the uses described on the product label. To the extent consistent with applicable law, SePRO Corporation makes no other express or implied warranty of fitness or merchantability nor any other express or implied warranty and any such warranties are expressly disclaimed.

**Misuse:** Federal law prohibits the use of this product in a manner inconsistent with its label directions. To the extent consistent with applicable law, the buyer assumes responsibility for any adverse consequences if this product is not used according to its label directions. In no case shall SePRO Corporation be liable for any losses or damages resulting from the use, handling or application of this product in a manner inconsistent with its label.

For additional important labeling information regarding SePRO Corporation's Terms and Conditions of Use, Inherent Risks of Use and Limitation of Remedies, please visit <http://seprolabels.com/terms> or scan the image below.



**Need help? A SePRO Pond Advisor can remotely and accurately measure the size of your pond and discuss a personalized strategy to keep your pond clear of unwanted algae. Call us TOLL FREE at 1-844-766-2727 or email [service@seprototal.com](mailto:service@seprototal.com)**

©Copyright 2017 SePRO Corporation  
SePRO Total Pond - Emerge is a trademark of SePRO Corporation  
FPL20151119  
EPA Reg. No. 62719-324-67690



**SePRO Corporation**  
11550 North Meridian Street, Suite 600  
Carmel, IN 46032, U.S.A.